

Slanted chamber wick

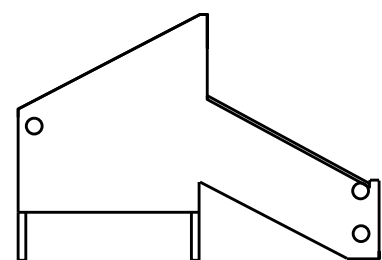

Facade

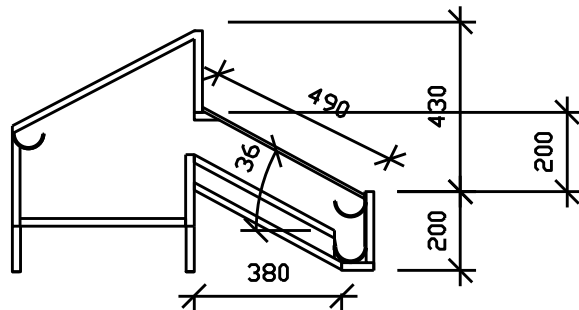

Section B - B

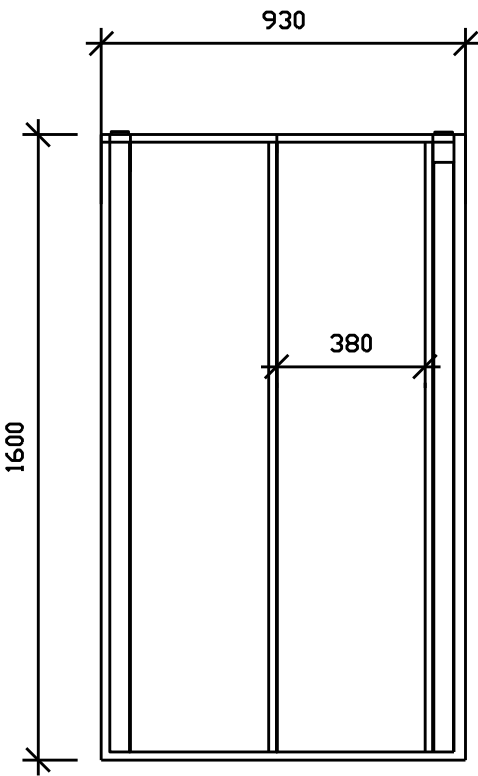

PLAN

Double chamber wick

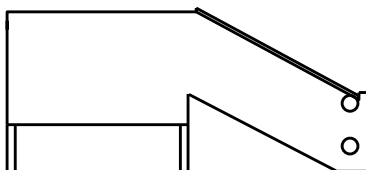

Facade

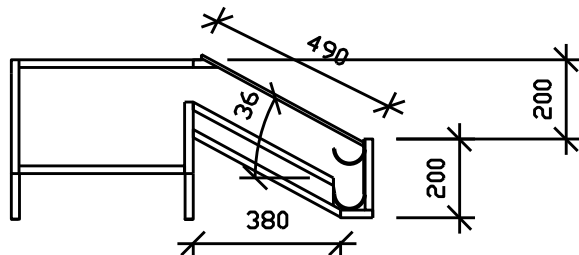

Section B - B

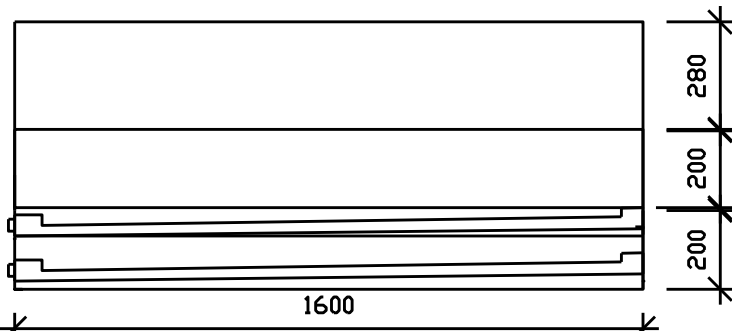

Section A - A

Rev.	Tekst:	Rev.dato:	Kontr:
00-			
-			
-			
-			
-			
-			
-			
-			

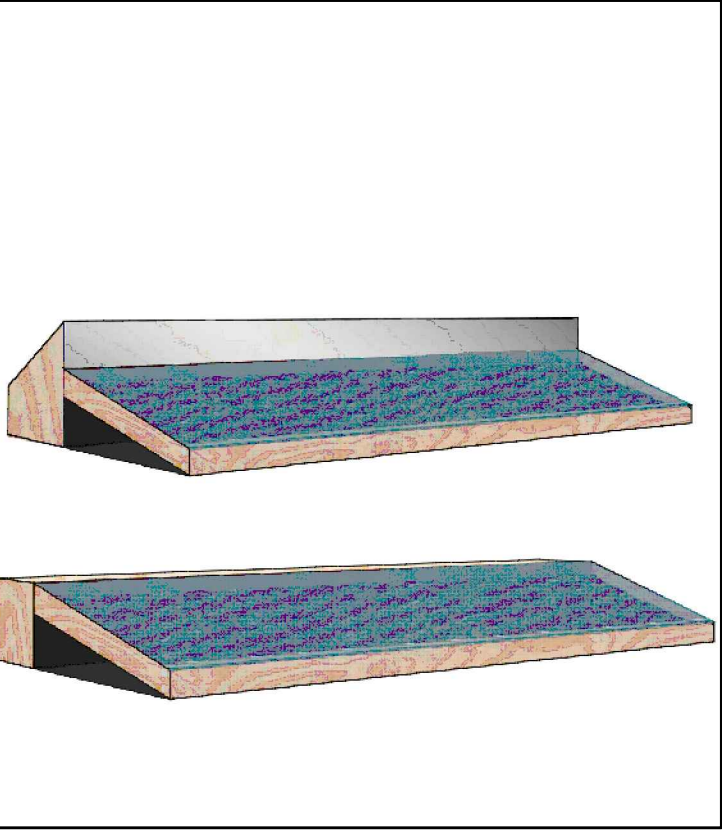

Wick still

Prosjekt:
Solarstills, Faryab

Oppdragsgiver:
MRRD

Oppdragsleder:
SS

Oppdragsnr.:
529761

Tegn:
IMP

Kontr:

Målestokk:
1:20

Dato:

Tegn. nr:
V K

Fag Type Etg.

003

Løpenr.

Rev.
XX- X